

10 inch Subwoofer

- **High Excursion**
- **Very Low Distortion**
- **No Stray Magnetic Fields**

Nominal Diameter10 inches (268 mm)
 Nominal Impedance (Z) 4 ohms
 Sensitivity, 1W/1m (E) 83 dB @ 200 Hz
 Power Capacity, RMS (Pe) 400 W
 Power Capacity, Peak 1600 W
 Frequency Range (-10dB) Fo - 1.5 kHz
 Minimum Impedance 5 ohms
 Voice Coil Diameter 79.4 mm
 Voice Coil Winding Length (h) 15.4 mm
 Voice Coil Number of Layers (n) 1
 Voice Coil Former Material Glass composite
 Voice Coil Wire Composition Aluminum Ribbon
 Magnetic Material Neodymium radial
 Stray Flux Shielding Inherent
 Magnetic Gap Depth (He) 38.1 mm
 Cone Material Aluminum
 Surround Material Injecton molded rubber
 Polarity, Outward Motion Positive voltage on (+) termin
 Net Weight 7.7 kg
 Maximum Excursion 60 mm peak to peak

Thiele / Small Parameters

Resonant Frequency (Fo) - Fs 32 Hertz
 Voice Coil DC Resistance - Re 3.6 ohms
 Total Q - Qts 0.4
 Mechanical Q - Qms 7.8
 Electrical Q - Qes 0.42
 Equivalent Volume of Air - Vas 33 L
 Radiating Piston Area - Sd 317 cm²
 Xmax 36 mm peak to peak

Electrical / Mechanical Parameters

Flux Density x Length - BL 13 Tesla-meters
 Compliance - Cms 236 μm/N
 Total Mass - Mms 103 grams

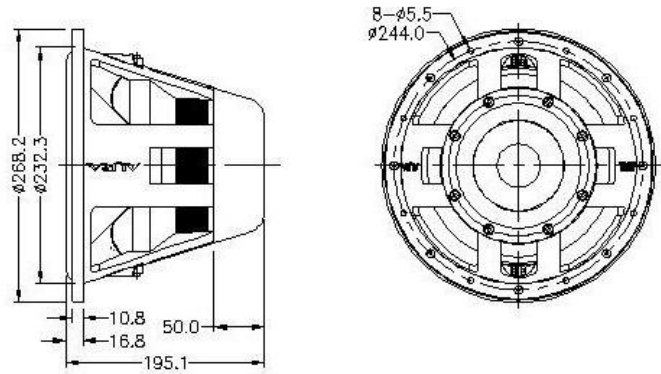

Frequency Response (1W, 1m)

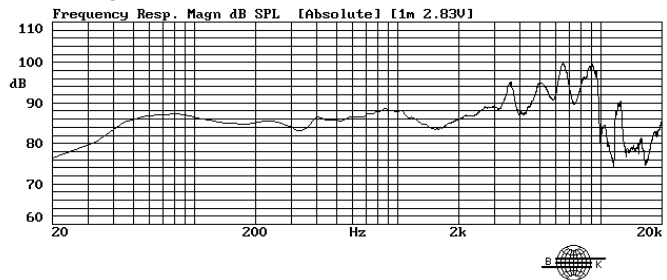

Impedance

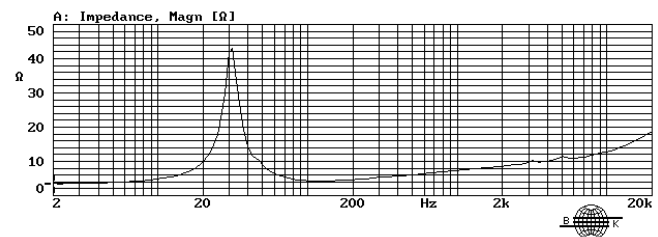

Distortion (1W, 1m)

